

DRAFT MAP

Town of Chocowinity

Beaufort County, North Carolina

DRAFT MAP

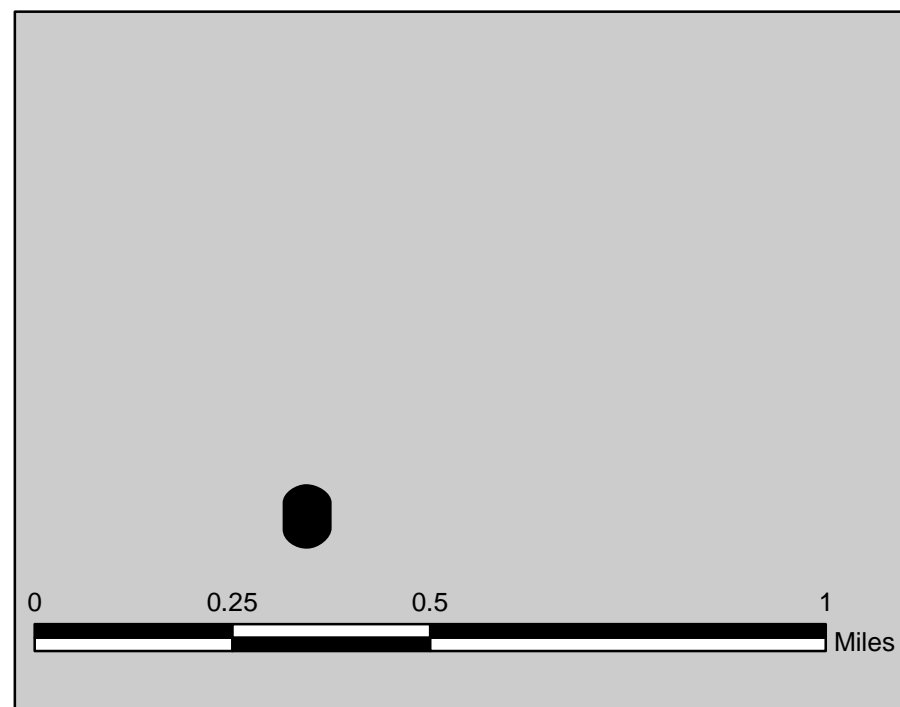
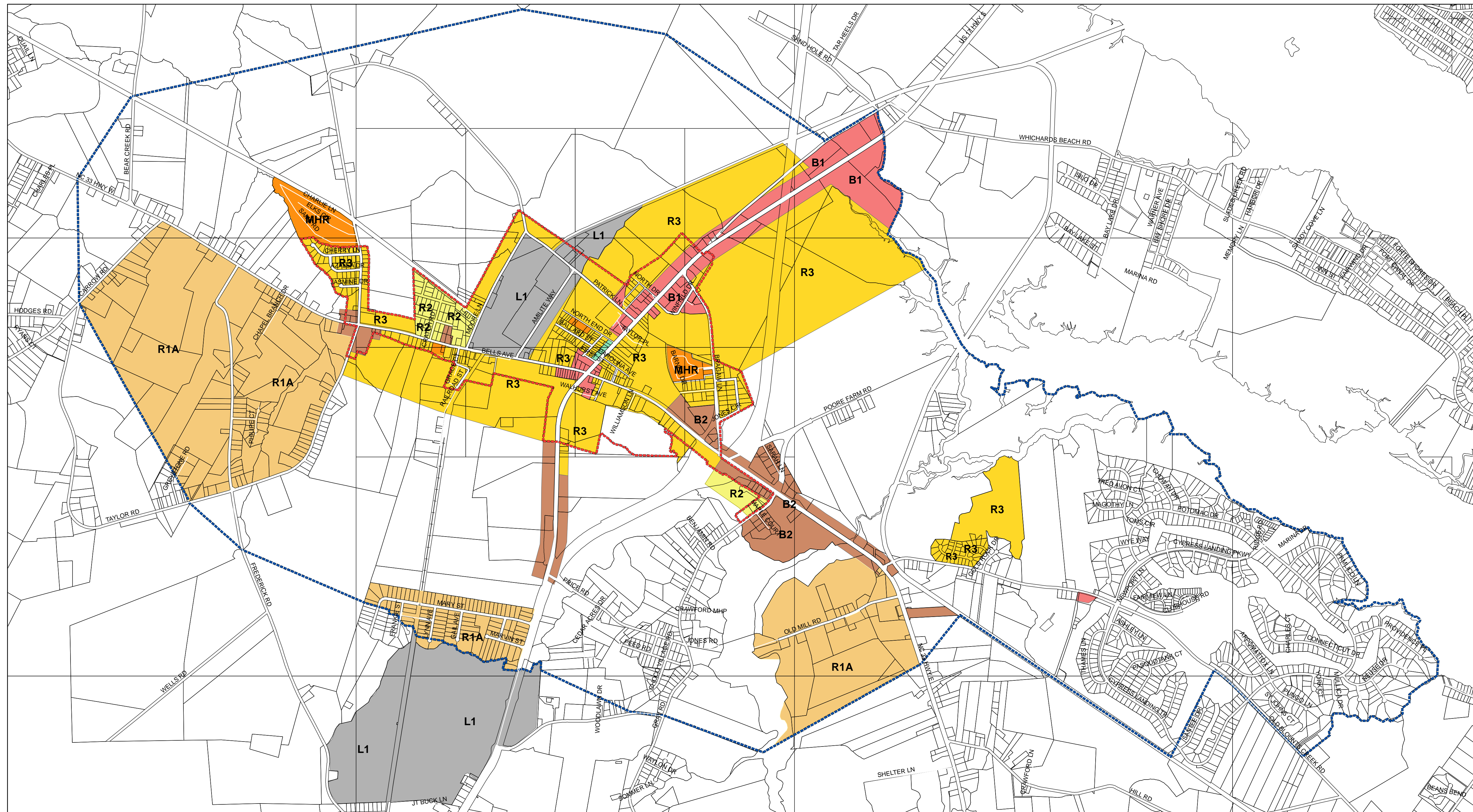

Legend

Chocowinity Corporate Limits	B1 General Business	MHR Mobile Home Residential	R3 Medium Density Residential
Extraterritorial Jurisdiction	B2 Highway Business	R1 Low Density Residential	R3 Residential Conditional Use Business Overlay
beauparcels	L1 Light Industrial	R1A Low Density Residential	
	R2 Limited Low Density Residential		

Prepared by:
Bryant Buck
Mid-East Commission
PO Box 1787
Washington, NC 27889

Tim Ware, Executive Director
Eddy Davis, Planning Director
April 21, 2010

Parcel Data: March 15, 2010

This map represents a compilation of information from multiple sources, and at different scales, which may result in inconsistencies among the features represented on this map. The Mid-East Commission assumes no responsibility for the accuracy of the source information.